

2836 QUARTER RD, HOPKINTON

Deed: BRADKE, VIRGINIA B ESTATE & BRADKE, CRAIG S  
 Contract: Map Area: Union Twp-A  
 CID#: Route: 914-001-040  
 DBA: Tax Dist: 370 UNION MV  
 MLS: Plat Page:  
 Subdiv: NONE

Checks/Tags:  
 Lister/Date: RF, 06/16/2009  
 Review/Date: DS, 10/13/2009  
 Entry Status: Estimated

Rural / Ag Dwelling

Legal: Section: 002; Twp: 087; Rng: 004; Block: ; Lot: ; Deeded Acres: 0.000  
 W 1/2 NW

**Land**

Land Basis	Front	Rear	Side 1	Side 2	R. Lot	SF	Acres	Depth/Unit	EFF/Type	Qual./Land						
CR							68.520									
*NON							8.440									
<b>Grand Total</b>						3,352,377.60	76.960									

**Street**

**Utilities**

**Zoning**

**Land Use**

CR	None	None	None	Not Applicable	Cropland
*NON	None	None	None	Not Applicable	Non-Crop

**Sales**

**Building Permits**

**Values**

Date	\$ Amount	NUTC	Recording	Date	Number	Tag	\$ Amount	Reason	Type	Appraised	B of R	St. Equalized	
06/03/2017	\$0	D14	2017-1552						Land	\$164,200	\$0	\$0	\$164,200
									LandC		\$0	\$0	
									Dwlg	\$47,200	\$0	\$0	\$47,200
									Impr	\$28,700	\$0	\$0	\$28,700
									<b>Total</b>	<b>\$240,100</b>	<b>\$0</b>	<b>\$0</b>	<b>\$240,100</b>

Res. Structure		Finish				Plumbing		Addition		Garage	
Occ. Code	101	Ttl Rooms Above #	7	Bedrooms Above #	3	Full Bath	1	Addition	1 of 1	Garage	1 of 1
Occ. Descr.	Single-Family / Owner Occupied	Ttl Rooms Below #	0	Bedrooms Below #	0	Shower Stall Bath		Year Built	1900	Style	Det Frm
Year Built	1900					Toilet Room		EFA	115	W X L	23' X 20'
EFA / EFYr	115 / 1900					Lavatory		EFA Year	1900	Area (SF)	460
Arch. Dsgn	N/A	Foundation	Stn			Water Closet		Style	1 Sty Frm	Year Built	1920
Style	1 1/2 Story Frame	Exterior Walls	Vinyl			Sink		Area (SF)	336	EFA	95
AreaSF	640 /	Roof	Asph / Gable			Shower Stall/Tub		Condition	Normal	EFF Year	1920
		Interior Finish	Plas / Panel			Mtl St Sh Bath		Bsmt (SF)		Condition	A NML
		Flooring	Carp / Vinyl			Mtl Stall Shower		NoBsmt Flr(SF)		Bsmt (SF)	
		<b>Non-base Heating</b>		<b>Fireplace</b>		No Bathroom		Heat	FHA - Gas	Qtrs Over	None
		Floor/Wall #	0			Wet Bar		AC	Yes	Qtrs Over (SF)	
		Pipeless #	0			Whirlpool Bathroom		Attic (SF)		Qtrs AC (SF)	
		Hand Fired (Y/N)	No			Whirlpool Tub				Door Opnrs	
Condition	NML	Space Heat #	0			No Hot Water Tank				Stalls- Bsmt / Std	
		<b>Appliances</b>				No Plumbing					
		Range Unit	Built-In Vacuums			Sewer & Water Only					
Basement	1/2	Oven - Single	Intercom System			Water Only w/Sink					
No Bsmt Flr.	0	Oven - Double	BI Stereo			Hot Tub					
Heat	FHA - Gas	Dishwasher	1			Bidet					
AC	Yes	Microwave				Fbgls Service Sink					
Attic	None	Trash Compactor				Urinal					
		Jennair				Sauna					
		Security System				W'Pool Bath w/Shower					



Bldg / Addn	Description	Units	Year						
	101 — Single-Family / Owner Occupied								
	1 1/2 Story Frame	640							
	Adjustment for basement - 1/2								
	Base Heat: FHA - Gas								
	Add Central Air	640							
#1	Porch: 1S Frame Screen	240 SF							
#2	Porch: 1S Frame Enclosed	192 SF							
	B.I. Appliances	1							
Adtn	1 Story Frame	336 SF		1900					
	Garage: Det Frame 23' X 20'	460 SF		1920					



Prior Year	Comment	Value Type	Location	Class	Land Value	Dwelling Value	Improvement Value	M & E Value	Total Value
2017	w/Ex: \$240,100 Total; \$164,200 Land; \$47,200	Appr	Rural	Ag Dwlg	\$164,200	\$47,200	\$28,700	\$0	\$240,100
2016		Appr	Rural	Ag Dwlg	\$206,300	\$44,800	\$42,200	\$0	\$293,300
2015		Appr	Rural	Ag Dwlg	\$206,300	\$44,800	\$42,300	\$0	\$293,400
2014		Appr	Rural	Ag Dwlg	\$160,200	\$50,300	\$52,400	\$0	\$262,900
2013		Appr	Rural	Ag Dwlg	\$160,200	\$50,300	\$52,400	\$0	\$262,900
2012		Appr	Rural	Ag Dwlg	\$107,500	\$50,300	\$39,500	\$0	\$197,300
2011		Appr	Rural	Ag Dwlg	\$107,500	\$50,300	\$39,600	\$0	\$197,400
2010		Appr			\$81,100	\$50,300	\$52,100	\$0	\$183,500

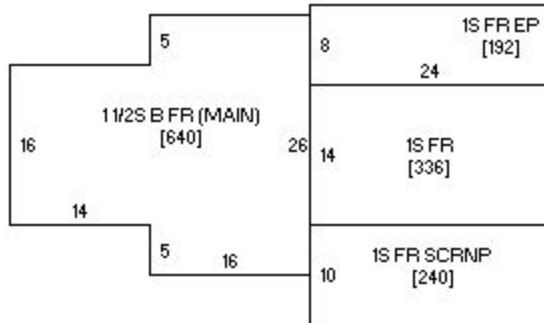

Sketch 1 of 1



Exempt Reason	Start Year End Date					Exempt Acres CSR Points
Right of Way	2016 01/01/2300					2.000 0.000





